



INSTALLATION RECOMMENDATIONS FOR GREAT STUFF PRO™ Wall & Floor Adhesive

GREAT STUFF PRO™ Wall & Floor Adhesive is a heavy-duty adhesive specially formulated to bond subfloors, drywall, paneling, foam panels and most construction materials. Different from traditional adhesives because of its excellent bonding power on dry, damp and even frozen lumber, GREAT STUFF PRO Wall & Floor Adhesive provides a fast-grab tack and long-term high-strength bond. It bonds to lumber, plywood, particle board, masonry, drywall, concrete and foam panels. It is ideal for anchoring, joining and stabilizing insulated concrete forms and structural insulated panels. GREAT STUFF PRO™ Gaps & Cracks Insulating Foam Sealant can be used to seal gaps in the forms and prevent concrete leakage during the pouring stage.

Getting Ready

Materials and Equipment

- GREAT STUFF PRO™ Wall & Floor Adhesive
- PRO Series foam dispensing guns (Figure 1)
- Protective wear, including goggles, gloves and proper clothing
- Dry cloth, putty knife or paint scraper
- GREAT STUFF PRO™ Gun Cleaner, acetone, or other adhesive remover

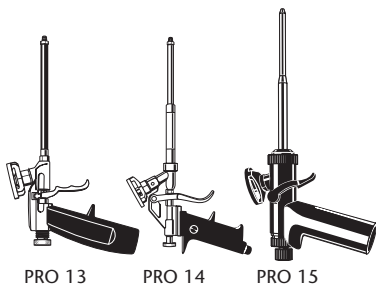

Figure 1

Conditions of Use

- Use GREAT STUFF PRO™ Wall & Floor Adhesive in a well-ventilated area or with proper respiratory protection. The adhesive may cause sensitization by inhalation and/or skin contact.
- GREAT STUFF PRO™ Wall & Floor Adhesive is flammable during dispensing. Shut off all gas pilot lights, electrical igniters and other sources of ignition (e.g., candles, space heaters and halogen lamps) before and during use. Do not smoke or use matches/lighters while dispensing foam.
- Apply at temperatures between 32°F and 100°F (0°C and 38°C).
- Contents of the can are under pressure. Do not place in hot water, puncture, incinerate or store at temperatures above 120°F (49°C). Can may burst if left in areas susceptible to high temperatures, such as motor vehicles or near radiators, stoves or other sources of heat.
- Extremely cold temperatures can affect dispensing performance.
- GREAT STUFF PRO™ Wall & Floor Adhesive is extremely sticky and difficult to remove from skin, clothing and surfaces. Avoid contact with skin and eyes. Wear glasses or goggles, and gloves when using GREAT STUFF PRO Wall & Floor Adhesive.

Preparation

1. Remove all contaminants (water, oil, dust, dirt, debris or other loose materials or release agents) that may affect the adhesion between the substrates. If in doubt, conduct an adhesion test, waiting at least one hour to assess the bond.

2. If the surface area has been previously painted, scrape away all loose or poorly adhered paint and sand or thoroughly roughen the surface. Conduct an adhesion test if any previously painted surfaces are to be bonded.
3. Whenever possible, allow any concrete or masonry substrates to completely cure before bonding.
4. Shake can vigorously for one minute before dispensing or between uses.
5. Invert can and screw foam dispensing gun firmly onto valve as shown in Figure 2. Screw until finger-tight; do not overtighten (Figure 3).



Figure 2

TIP
Using grease or petroleum jelly in the adapter of the gun can reduce possibility of foam gluing the can on the gun.

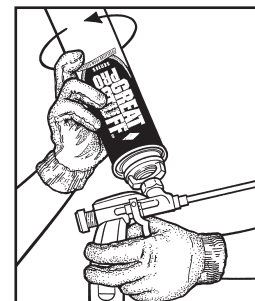

Figure 3

- When changing cans, tighten the flow control knob before removing the empty can (Figure 4). Use GREAT STUFF PRO™ Gun Cleaner to remove any residual foam from the attachment area before attaching fresh can. Always replace can immediately. Press the trigger to fill the foam dispensing gun with adhesive.

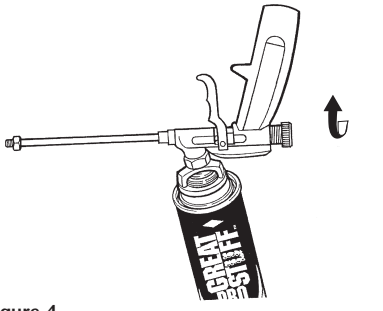

Figure 4

- Dispense adhesive for 3-6 seconds to purge air from gun.
- To control size of adhesive bead, squeeze trigger on the foam dispensing gun or adjust the flow control knob on the back of the gun (Figure 5).

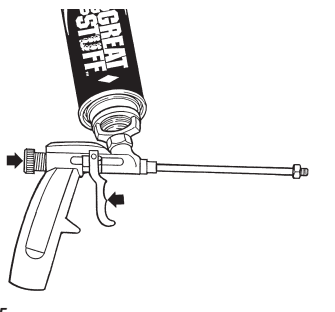

Figure 5

Application

- Keeping can inverted, apply a 1/2" (13 mm) bead of adhesive the full length of each stud or joist (Figures 6 and 7).

TIP

Apply adhesive in a continuous bead, with no voids or breaks, to achieve an effective bond.

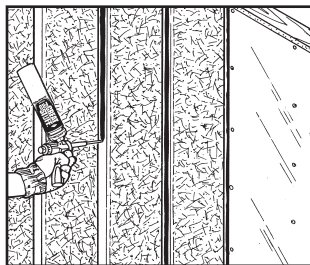

Figure 6

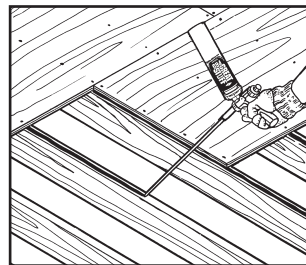

Figure 7

- Wherever sheet materials butt together along sistered studs or joists, dispense two 1/2" (13 mm) beads side by side or one 1/2" (13 mm) bead in a zigzag pattern the full length of the sistered studs or joists (Figures 8 and 9).

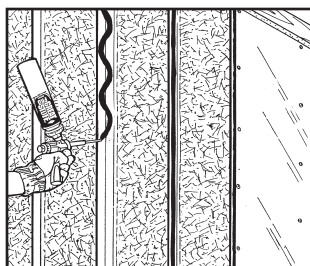

Figure 8

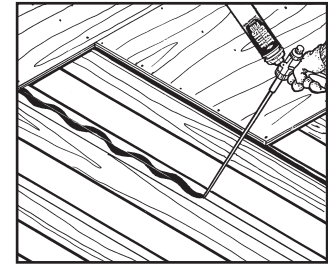

Figure 9

TIP

Always close the flow control knob when the gun is not in use.

- Clean foam dispensing gun periodically by rubbing the nozzle on soft wood to free it from adhesive. Do not use a sharp object to clean foam dispensing gun. Use a solvent cleaner such as GREAT STUFF PRO™ Gun Cleaner between extended periods of non-use.
- Adhere substrates within 10 minutes of dispensing adhesive. If the applied bead has skinned over, scrape it off and apply a new bead.
- Mechanical fasteners must be installed soon after adhesive application in all cases. Assemblies must be compressed to enable GREAT STUFF PRO™ Wall & Floor Adhesive to aggressively bond to the materials. Mechanical fasteners should be installed within 15 minutes after applying for best bond.

NOTE: GREAT STUFF PRO™ Wall & Floor Adhesive reaches initial bond within two hours, and is fully cured in about seven days. Cure times will be shorter at higher temperature and humidity, and longer at lower temperature and humidity.

TIP

Never leave a foam dispensing gun without a can of adhesive attached unless it has been thoroughly cleaned with GREAT STUFF PRO™ Gun Cleaner.

Cleanup

- Excess adhesive can be cleaned from the substrate while still uncured using a dry cloth, putty knife or paint scraper. Uncured adhesive can be removed with GREAT STUFF PRO™ Gun Cleaner. Cured adhesive must be mechanically removed or allowed to wear off in time.
- For short-term storage, tighten the flow control knob until fully closed. Use can within 30 days of initial use. Store upright with foam dispensing gun attached. To reuse, shake vigorously for one minute before dispensing. Adjust flow control knob to the open position.
- For long-term storage, unscrew can and use GREAT STUFF PRO Gun Cleaner to clean uncured adhesive from the exterior assembly. To clean the foam dispensing gun's interior assembly, invert can of cleaner and screw onto adapter, being careful not to overtighten. Spray until all adhesive is blown out of the foam dispensing gun and only cleaner is visible (approximately half the can of cleaner will be used). Allow the gun containing the solvent to sit for several minutes and repeat with a second flush.
- Use GREAT STUFF PRO™ Wall & Floor Adhesive and GREAT STUFF PRO Gun Cleaner only in well-ventilated areas. See the MSDS for respiratory protection requirements. Solvent and propellant are flammable.
- Do not leave a can of cleaner mounted on the foam dispensing gun. This will dissolve the lip seals inside the gun and render it useless. Foam escaping at the handle or trigger indicates a faulty seal.

NOTE: If this happens, the gun should be replaced. If the foam dispensing gun has not been cleaned, add a new can of GREAT STUFF PRO™ Wall & Floor Adhesive immediately. If left without a can attached, exposure to air and moisture will cause the foam in the gun to cure. A fresh can of adhesive may be left attached to a foam dispensing gun that has been cleaned for up to 30 days.

TIP

Treat your gun like a tool. The better you take care of it, the longer it will last.

IN THE U.S.:

- For Technical Information: **1-866-583-BLUE (2583)**
- For Sales Information: **1-800-232-2436**

THE DOW CHEMICAL COMPANY

- Dow Building Solutions • 200 Larkin • Midland, MI 48674
- www.sprayfoamatdow.com**

IN CANADA:

- For Technical Information: **1-866-583-BLUE (2583)** (English); **1-800-363-6210** (French)
- For Sales Information: **1-800-232-2436** (English); **1-800-565-1255** (French)

DOW CHEMICAL CANADA INC.

- Dow Building Solutions • Suite 2100 • 450 – 1st St. SW • Calgary, AB T2P 5H1
- www.sprayfoamatdow.ca**

NOTICE: No freedom from any patent owned by Dow or others is to be inferred. Because use conditions and applicable laws may differ from one location to another and may change with time, Customer is responsible for determining whether products and the information in this document are appropriate for Customer's use and for ensuring that Customer's workplace and disposal practices are in compliance with applicable laws and other government enactments. Dow assumes no obligation or liability for the information in this document. NO WARRANTIES ARE GIVEN; ALL IMPLIED WARRANTIES OF MERCHANTABILITY OR FITNESS FOR A PARTICULAR PURPOSE ARE EXPRESSLY EXCLUDED.

COMBUSTIBLE: Protect from high heat sources. Local building codes may require a protective or thermal barrier. For more information, consult MSDS, call Dow at 1-866-583-BLUE (2583) or contact your local building inspector. In an emergency, call 1-989-636-4400 in the U.S. or 1-519-339-3711 in Canada.

NOTE: Read the Material Safety Data Sheet carefully before using GREAT STUFF PRO™ Wall & Floor Adhesive. GREAT STUFF PRO Wall & Floor Adhesive is extremely flammable. Keep away from all ignition sources such as high heat, sparks and flames. Wear protective clothing, glasses or goggles, and gloves. Provide adequate ventilation or wear proper respiratory protection.

Building and/or construction practices unrelated to building materials could greatly affect moisture and the potential for mold formation. No material supplier including Dow can give assurance that mold will not develop in any specific system.

a proud partner of

